

PIBOMULTI

SWISS

MADE



<http://www.pibomulti.com> - info@pibomulti.com
<http://www.pibomulti-na.com> - info@pibomulti-na.com

Large

BIG POWER!

Grande puissance - Grosser Leistung

FEC-50

Manual or automatic tool change

Manual and NC controlled



32 kW
515 kg
1'500 Nm
3'000 rpm

30 kW to 100 kW

2000 kg
100 kW

A person is standing next to a tall cabinet for scale.

FTARH 50



Manual and NC controlled

30 kW to 50 kW

SLIM LINE POWER



185 mm

30 kW
2000 Nm

Spindle Extention



30 kW
8'000 t/min

Spindle Speeder

FEC50-14



Carter Fonte
Serrage outil manuel
Positionnement 360° manuel

Cast Iron body
Manual tool clamping
Manual positioning 360°

Options :

Arrosage central
Broche HSK 100
Serrage outil automatique
Positionnement 360°, NC tous les 1°

Options :

Thru coolant
Spindle HSK 100
Automatic tool clamping
360°, NC positioning every 1°

DONNEES TECHNIQUES TECHNISCHE DATEN TECHNICAL DATA

Type de broche Spindeltyp Spindle type	ISO50 / BT50 Serrage manuel
N max. sortie N max. ausgang N max. output	2'000 t/min u/min rpm
Puissance Leistung Power	14 kW
Couple MAX. Drehmoment MAX. Torque MAX.	200 Nm
Rapport Verhältnis Ratio	i = 1 à 1

Puissance et couple maxi
Leistung und Drehmoment max
Power and torque max

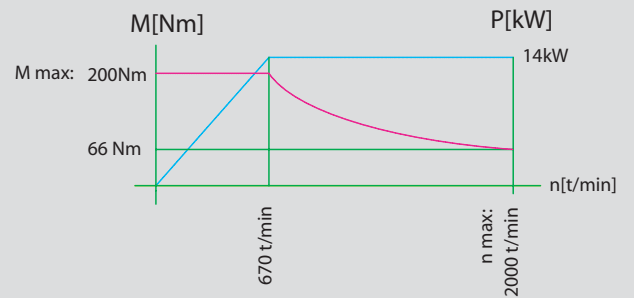

PIBOMULTI
SWISS MADE

PIBOMULTI
SWISS MADE

PIBOMULTI
SWISS MADE

PIBOMULTI
SWISS MADE

PIBOMULTI
SWISS MADE

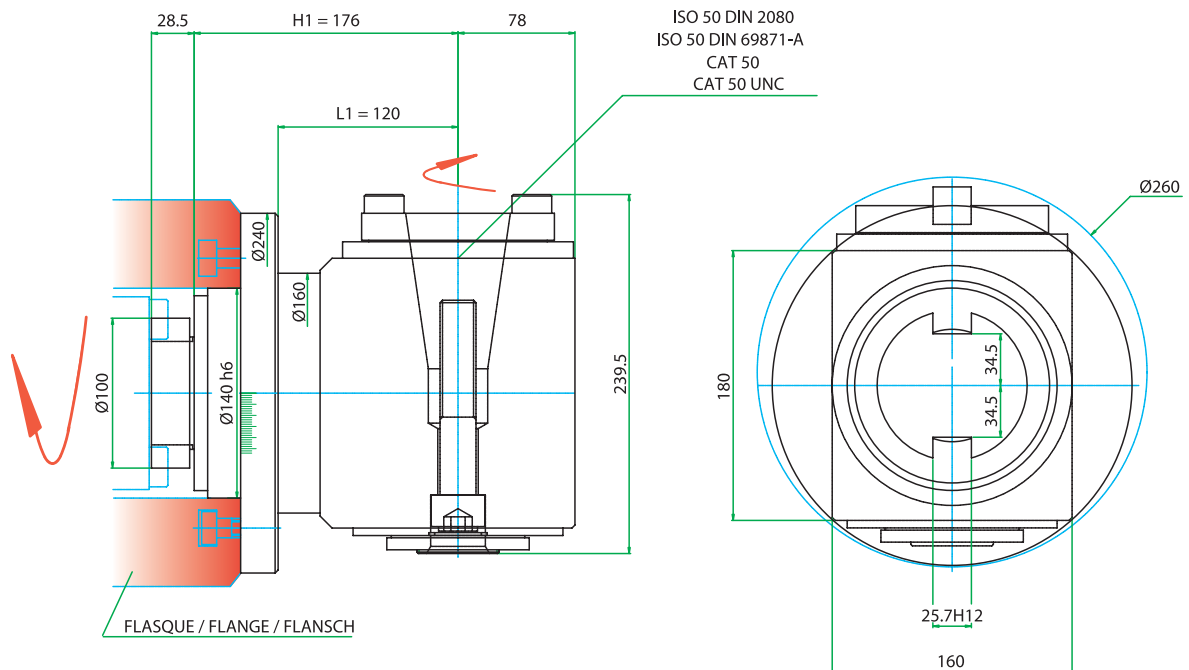

FEC50-20



Carter Fonte
Serrage outil manuel
Positionnement 360° manuel

Cast Iron body
Manual tool clamping
Manual positioning 360°

Options :

Arrosage central
Broche HSK 100
Serrage outil automatique
Positionnement 360°, NC tous les 1°

Options :

Thru coolant
Spindle HSK 100
Automatic tool clamping
360°, NC positioning every 1°

DONNEES TECHNIQUES TECHNISCHE DATEN TECHNICAL DATA

Type de broche Spindeltyp Spindle type	ISO50 / BT50 Serrage manuel
N max. sortie N max. ausgang N max. output	t/min u/min rpm 2'000
Puissance Leistung Power	20 kW
Couple MAX. Drehmoment MAX. Torque MAX.	600 Nm
Rapport Verhältnis Ratio	i = 1 à 1

Puissance et couple maxi
Leistung und Drehmoment max
Power and torque max

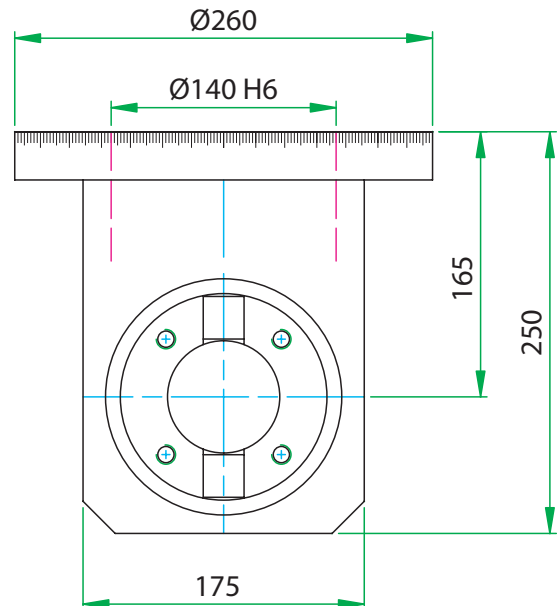
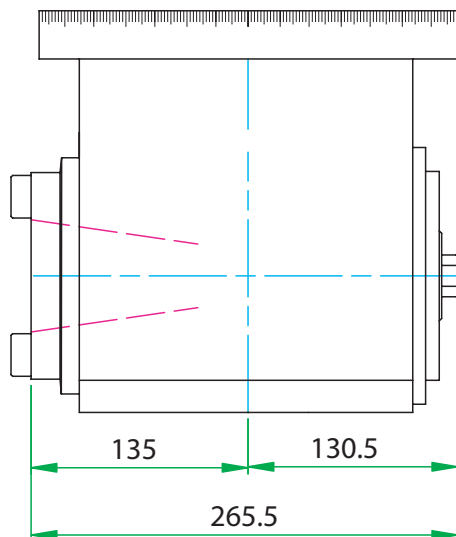
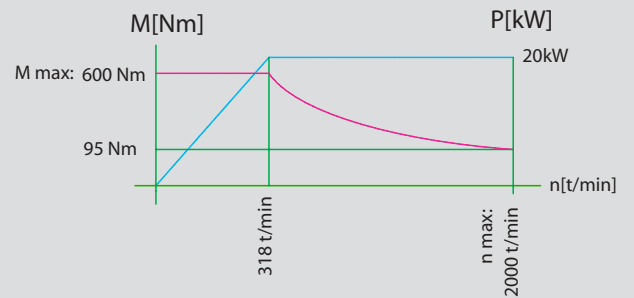

FEC50-30



Carter Fonte
Serrage outil manuel
Positionnement 360° manuel

Cast Iron body
Manual tool clamping
Manual positioning 360°

Options :

Arrosage central
Broche HSK 100
Serrage outil automatique
Positionnement 360°, NC tous les 1°

Options :

Thru coolant
Spindle HSK 100
Automatic tool clamping
360°, NC positioning every 1°

DONNEES TECHNIQUES TECHNISCHE DATEN TECHNICAL DATA

Type de broche Spindeltyp Spindle type	ISO50 / BT50 Serrage manuel
N max. sortie N max. ausgang N max. output	2'000 t/min u/min rpm
Puissance Leistung Power	30 kW
Couple MAX. Drehmoment MAX. Torque MAX.	1500 Nm
Rapport Verhältnis Ratio	i = 1 à 1

Puissance et couple maxi
Leistung und Drehmoment max
Power and torque max

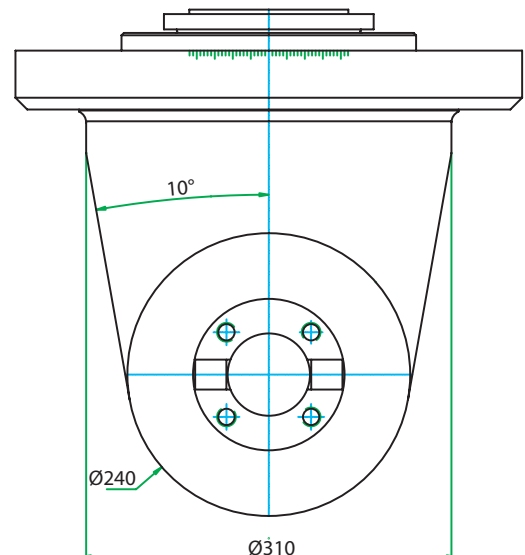
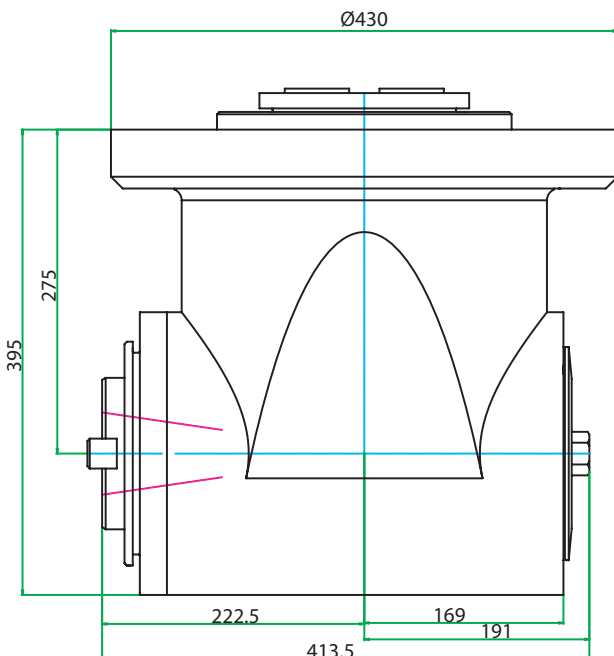
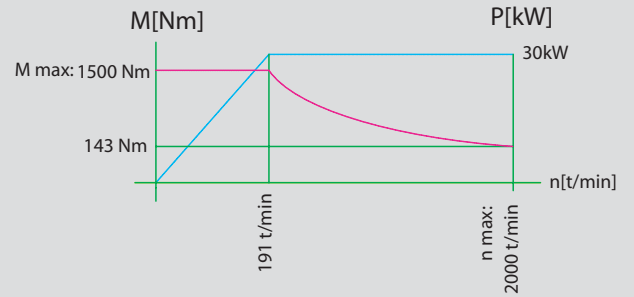

FEC50-NC30



Carter Fonte
Serrage outil automatique
**Positionnement 360°, NC tous les 1°
par moteur broche de la machine
Indexion par denture hirth**

Options :
Arrosage central
Broche HSK 100

Cast Iron body
Automatic tool clamping
**360°, NC positioning every 1°
by machine spindle motor
Hirth gear index**

Options :
Thru coolant
Spindle HSK 100

DONNEES TECHNIQUES TECHNISCHE DATEN TECHNICAL DATA

Type de broche Spindeltyp Spindle type	ISO50 / BT50 Serrage automatique
N max. sortie N max. ausgang N max. output	t/min u/min rpm 3'000
Puissance Leistung Power	30 kW
Couple MAX. Drehmoment MAX. Torque MAX.	1500 Nm
Rapport Verhältnis Ratio	i = 1 à 1

Puissance et couple maxi
Leistung und Drehmoment max
Power and torque max

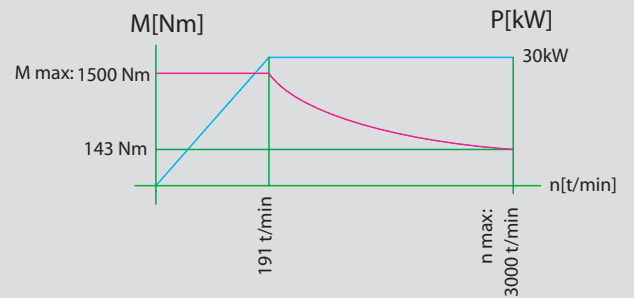

PIBOMULTI
SWISS MADE

PIBOMULTI
SWISS MADE

PIBOMULTI
SWISS MADE

PIBOMULTI
SWISS MADE

PIBOMULTI
SWISS MADE

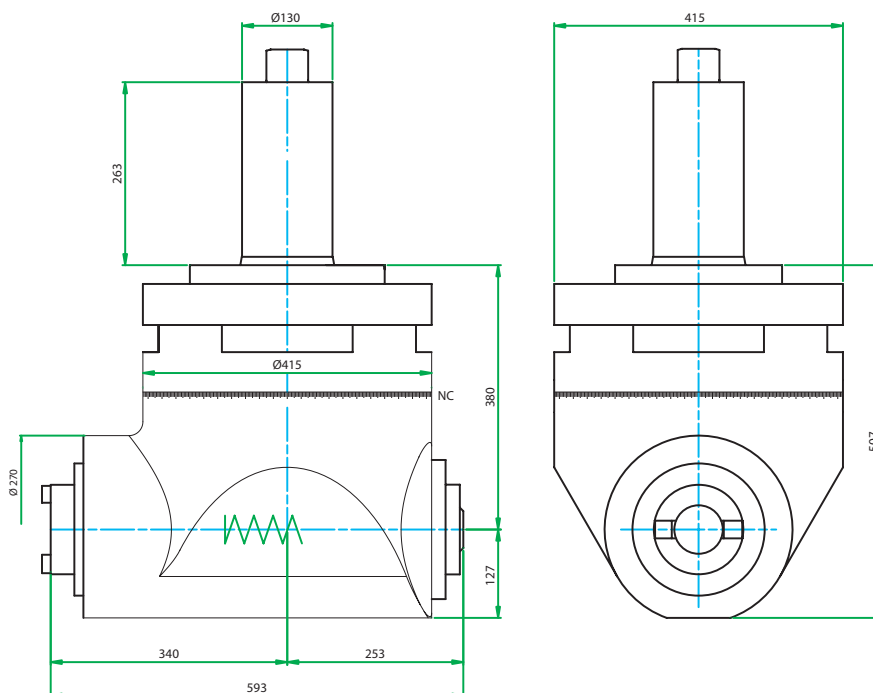

FEC50-40



Carter Fonte
Serrage outil manuel
Positionnement 360° manuel

Cast Iron body
Manual tool clamping
Manual positioning 360°

Options :
Arrosage central
Broche HSK 100
Serrage outil automatique
Positionnement 360°, NC tous les 1°

Options :
Thru coolant
Spindle HSK 100
Automatic tool clamping
360°, NC positioning every 1°

DONNEES TECHNIQUES TECHNISCHE DATEN TECHNICAL DATA

Type de broche Spindeltyp Spindle type	ISO50 / BT50 Serrage manuel
N max. sortie N max. ausgang N max. output	t/min u/min rpm 2'000
Puissance Leistung Power	40 kW
Couple MAX. Drehmoment MAX. Torque MAX.	3000 Nm
Rapport Verhältnis Ratio	i = 1 à 1

Puissance et couple maxi
Leistung und Drehmoment max
Power and torque max

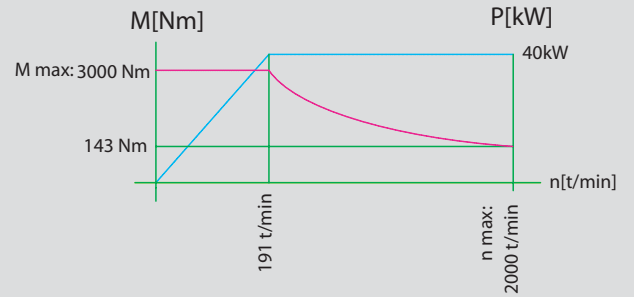

PIBOMULTI
SWISS MADE

PIBOMULTI
SWISS MADE

PIBOMULTI
SWISS MADE

PIBOMULTI
SWISS MADE

PIBOMULTI
SWISS MADE

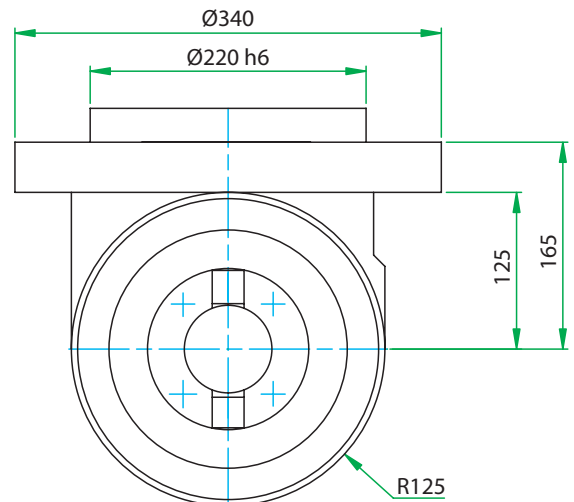
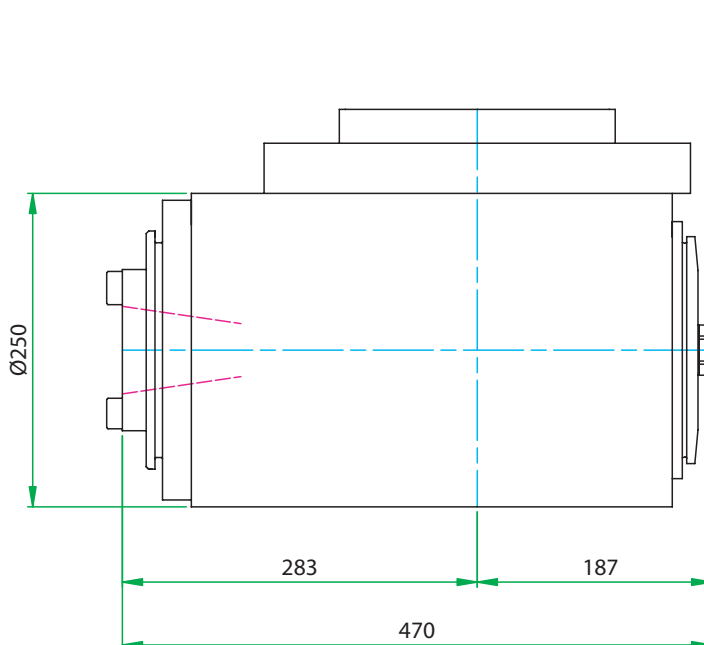

SLP40-15



Carter Fonte
Serrage outil manuel
Positionnement 360° manuel

Cast Iron body
Manual tool clamping
Manual positioning 360°

Options :
Broche HSK
Broche cyl. Porte fraise

Options :
Spindle HSK
Milling cutter flange mount spindle

DONNEES TECHNIQUES TECHNISCHE DATEN TECHNICAL DATA

Type de broche Spindeltyp Spindle type	ISO40 / BT Serrage manuel
N max. sortie N max. ausgang N max. output	t/min u/min rpm 1'500
Puissance Leistung Power	15 kW
Couple MAX. Drehmoment MAX. Torque MAX.	450 Nm à la broche
Rapport Verhältnis Ratio	i = 2 à 1

Puissance et couple maxi
Leistung und Drehmoment max
Power and torque max

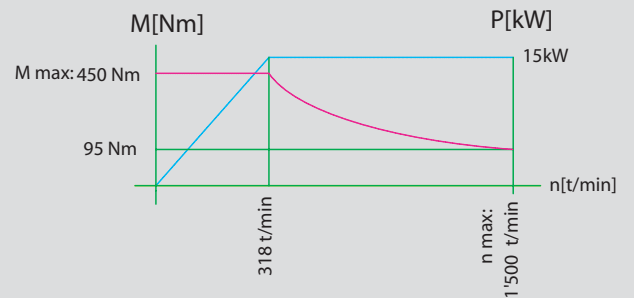

PIBOMULTI
SWISS MADE

PIBOMULTI
SWISS MADE

PIBOMULTI
SWISS MADE

PIBOMULTI
SWISS MADE

PIBOMULTI
SWISS MADE

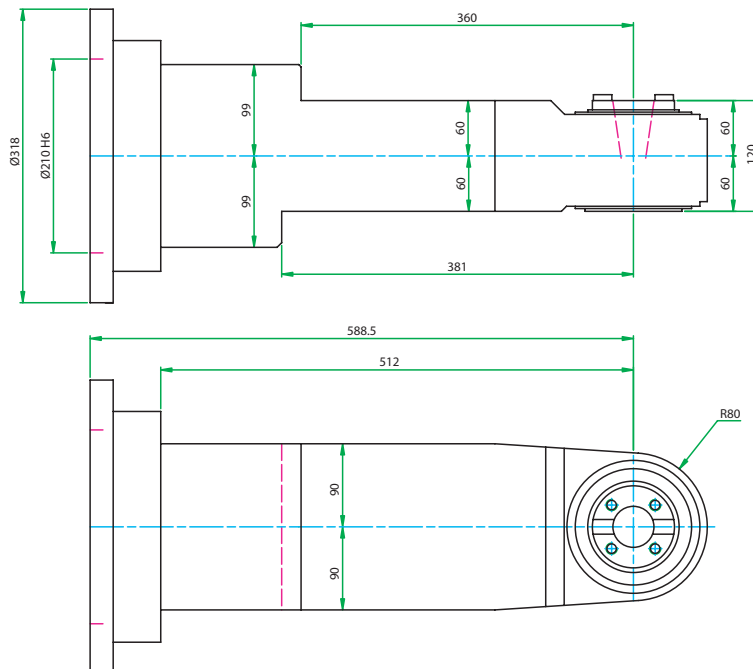

SLP50-22



Carter Fonte
Serrage outil manuel
Positionnement 360° manuel

Cast Iron body
Manual tool clamping
Manual positioning 360°

Options :
Broche HSK
Broche cyl. Porte fraise

Options :
Spindle HSK
Milling cutter flange mount spindle

DONNEES TECHNIQUES TECHNISCHE DATEN TECHNICAL DATA

Type de broche Spindeltyp Spindle type	ISO50 / BT Serrage manuel
N max. sortie N max. ausgang N max. output	500 t/min u/min rpm
Puissance Leistung Power	22 kW
Couple MAX. Drehmoment MAX. Torque MAX.	2200 Nm à la broche
Rapport Verhältnis Ratio	i = 2 à 1

Puissance et couple maxi
Leistung und Drehmoment max
Power and torque max

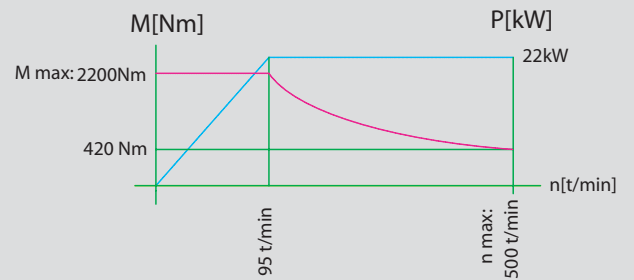

PIBOMULTI
SWISS MADE

PIBOMULTI
SWISS MADE

PIBOMULTI
SWISS MADE

PIBOMULTI
SWISS MADE

PIBOMULTI
SWISS MADE

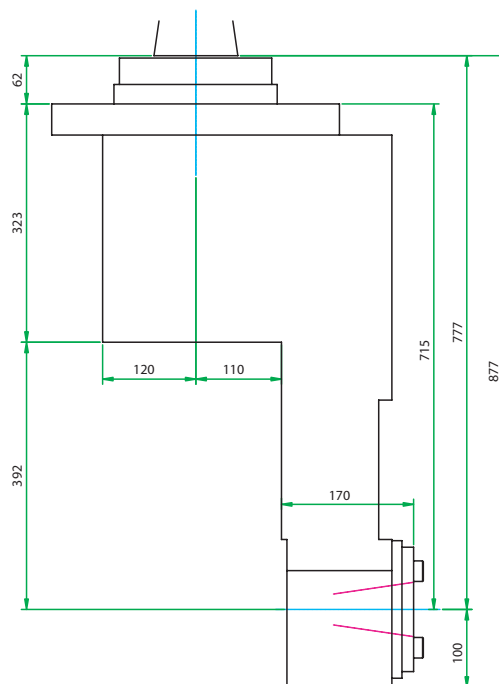
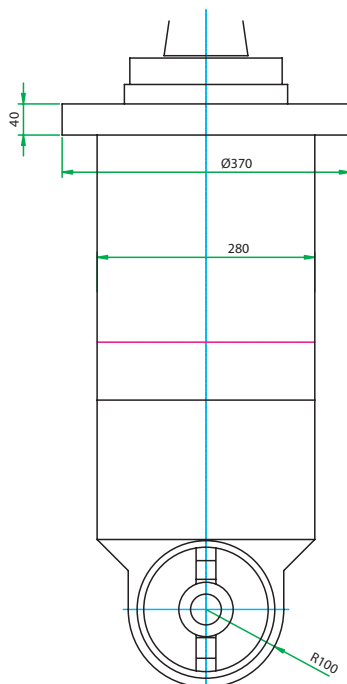

SLP50-30



Carter Fonte
Serrage outil manuel
Positionnement 360° manuel

Options :
Broche HSK
Broche cyl. Porte fraise

Cast Iron body
Manual tool clamping
Manual positioning 360°

Options :
Spindle HSK
Milling cutter flange mount spindle

DONNEES TECHNIQUES TECHNISCHE DATEN TECHNICAL DATA

Type de broche Spindeltyp Spindle type	ISO50 / BT Serrage manuel
N max. sortie N max. ausgang N max. output	t/min u/min rpm 2'000
Puissance Leistung Power	30 kW
Couple MAX. Drehmoment MAX. Torque MAX.	2000 Nm
Rapport Verhältnis Ratio	i = 1 à 1

Puissance et couple maxi
Leistung und Drehmoment max
Power and torque max

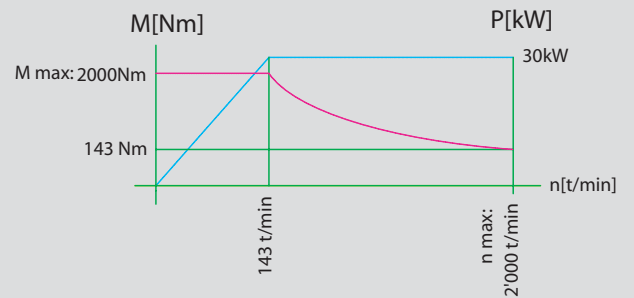

PIBOMULTI
SWISS MADE

PIBOMULTI
SWISS MADE

PIBOMULTI
SWISS MADE

PIBOMULTI
SWISS MADE

PIBOMULTI
SWISS MADE

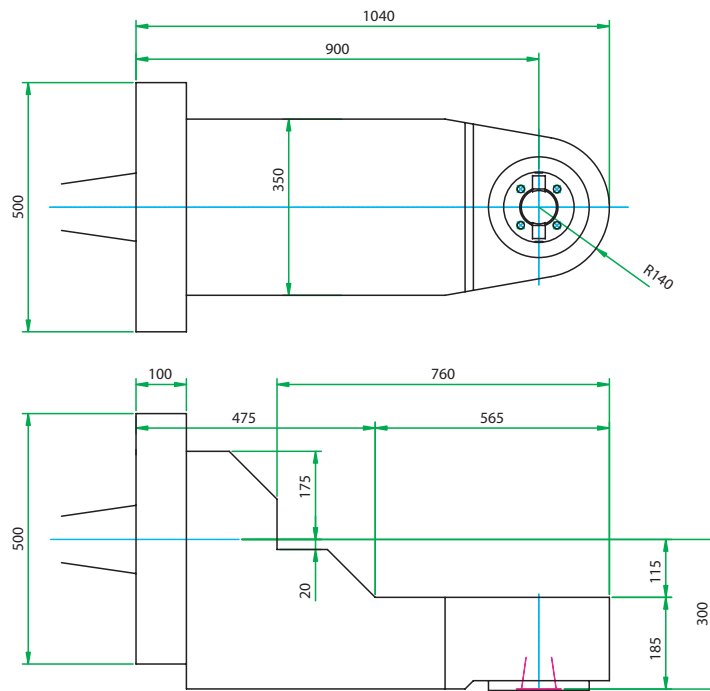

FTARH50-14



Carter Fonte
Serrage outil manuel
Positionnement +/- 120° manuel
Positionnement 360° manuel
Indexage par denture hirth

Options :

Arrosage central
Broche HSK 100
Serrage outil automatique
Positionnement +/- 120°, NC tous les 1°
Positionnement 360°, NC tous les 1°

Cast Iron body
Manual tool clamping
Manual positioning +/- 120°
Manual positioning 360°
Hirth gear positionning

Options :

Thru coolant
Spindle HSK 100
Automatic tool clamping
+/- 120°, NC positioning every 1°
360°, NC positioning every 1°

DONNEES TECHNIQUES TECHNISCHE DATEN TECHNICAL DATA

Type de broche Spindeltyp Spindle type	ISO50 / BT50 Serrage manuel
N max. sortie N max. ausgang N max. output	t/min u/min rpm 2'000
Puissance Leistung Power	14 kW
Couple MAX. Drehmoment MAX. Torque MAX.	350 Nm
Rapport Verhältnis Ratio	i = 1 à 1

Puissance et couple maxi
Leistung und Drehmoment max
Power and torque max

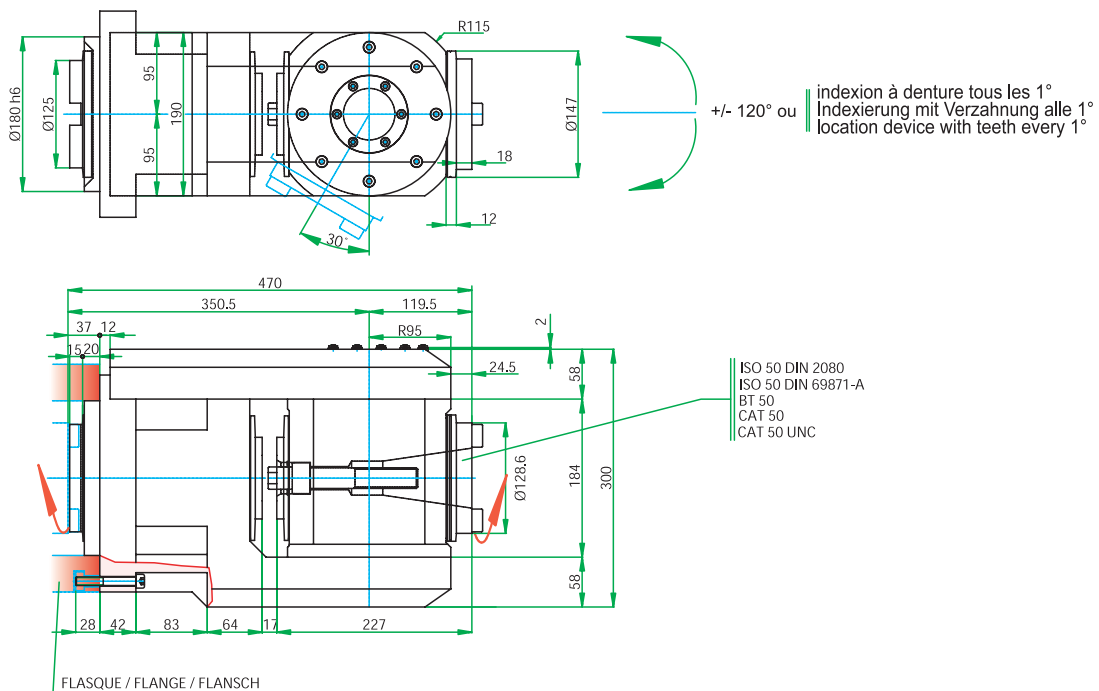
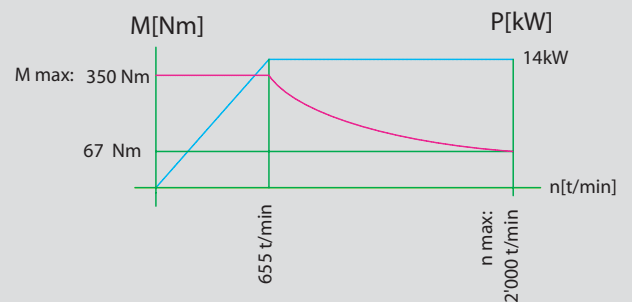

FTARH50-20



Carter Fonte
 Serrage outil manuel
 Positionnement +/- 120° manuel
 Positionnement 360° manuel
 Indexage par denture hirth

Options :
 Arrosage central
 Broche HSK 100
 Serrage outil automatique
 Positionnement +/- 120°, NC tous les 1°
 Positionnement 360°, NC tous les 1°

Cast Iron body
 Manual tool clamping
 Manual positioning +/- 120°
 Manual positioning 360°
 Hirth gear positionning

Options :
 Thru coolant
 Spindle HSK 100
 Automatic tool clamping
 +/- 120°, NC positionning every 1°
 360°, NC positionning every 1°

DONNEES TECHNIQUES TECHNISCHE DATEN TECHNICAL DATA

Type de broche Spindeltyp Spindle type	ISO50 / BT50 Serrage manuel
N max. sortie N max. ausgang N max. output	1800 t/min u/min rpm
Puissance Leistung Power	20 kW
Couple MAX. Drehmoment MAX. Torque MAX.	600 Nm
Rapport Verhältnis Ratio	i = 1 à 1

Puissance et couple maxi
 Leistung und Drehmoment max
 Power and torque max

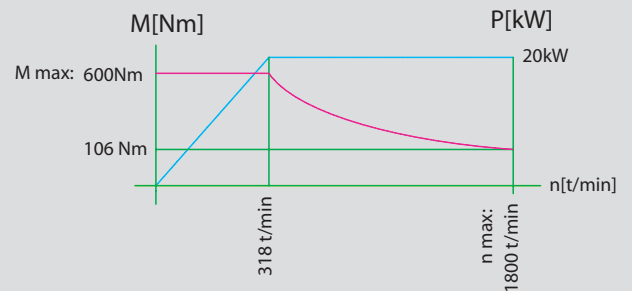

PIBOMULTI
 SWISS MADE

PIBOMULTI
 SWISS MADE

PIBOMULTI
 SWISS MADE

PIBOMULTI
 SWISS MADE

PIBOMULTI
 SWISS MADE

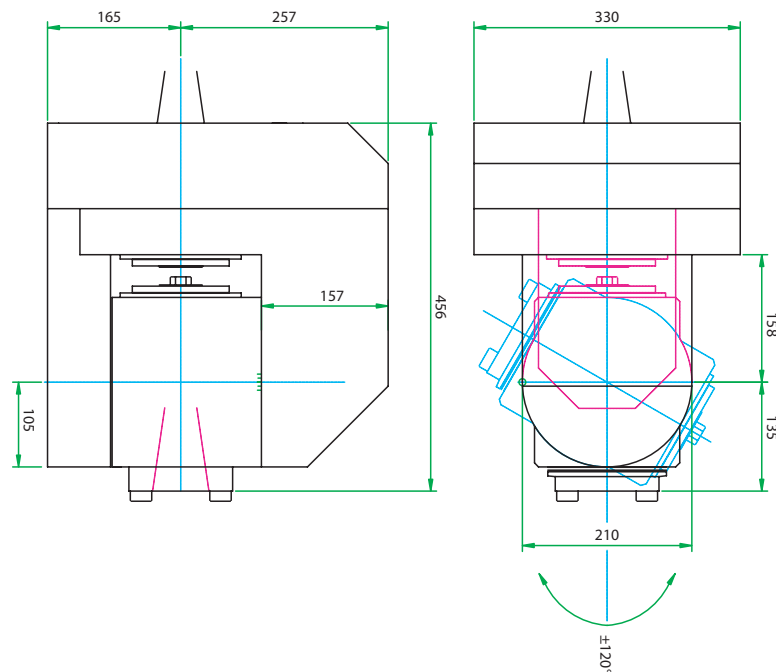

FTARH50-30



Carter Fonte
 Serrage outil manuel
 Positionnement +/- 120° manuel
 Positionnement 360° manuel
 Indexage par denture hirth

Options :
 Arrosage central
 Broche HSK 100
 Serrage outil automatique
 Positionnement +/- 120°, NC tous les 1°
 Positionnement 360°, NC tous les 1°

Cast Iron body
 Manual tool clamping
 Manual positioning +/- 120°
 Manual positioning 360°
 Hirth gear positionning

Options :
 Thru coolant
 Spindle HSK 100
 Automatic tool clamping
 +/- 120°, NC positionning every 1°
 360°, NC positionning every 1°

DONNEES TECHNIQUES TECHNISCHE DATEN TECHNICAL DATA

Type de broche Spindeltyp Spindle type	ISO50 / BT50 Serrage manuel
N max. sortie N max. ausgang N max. output	2000 t/min u/min rpm
Puissance Leistung Power	30 kW
Couple MAX. Drehmoment MAX. Torque MAX.	1500 Nm
Rapport Verhältnis Ratio	i = 1 à 1

Puissance et couple maxi
 Leistung und Drehmoment max
 Power and torque max

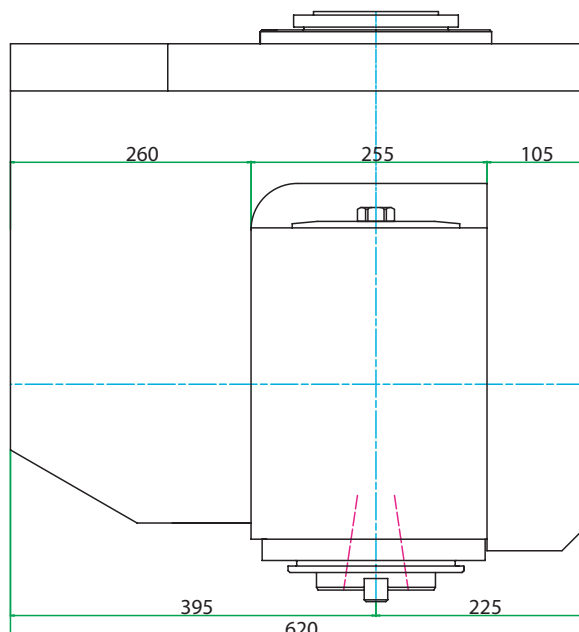
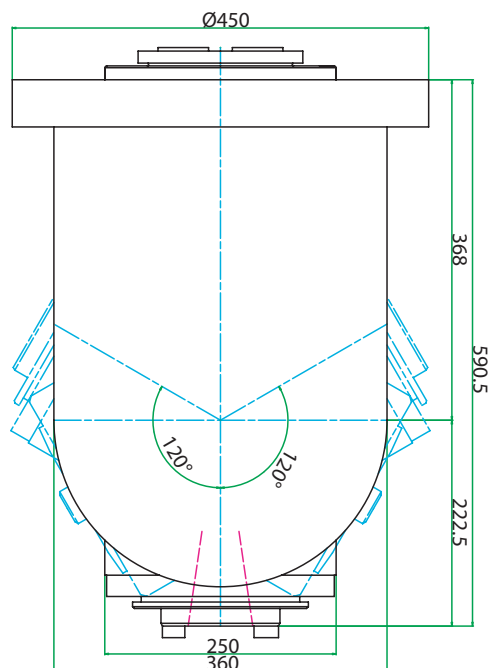
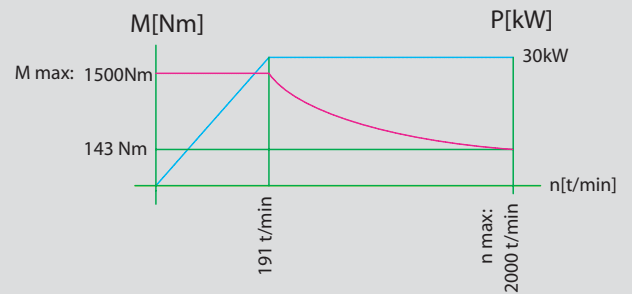

FTARH50-NC30



Carter Fonte
Serrage outil automatique
**Positionnement 360° et +/- 120°,
NC tous les 1°
par moteur broche de la machine**
Indexion par denture hirth

Options :
Arrosage central
Broche HSK 100

Cast Iron body
Automatic tool clamping
**360° et +/-120° NC positioning
every 1°
by machine spindle motor**
Hirth gear index

Options :
Thru coolant
Spindle HSK 100

DONNEES TECHNIQUES TECHNISCHE DATEN TECHNICAL DATA

Type de broche Spindeltyp Spindle type	ISO50 / BT50 Serrage manuel
N max. sortie N max. ausgang N max. output	2000 t/min u/min rpm
Puissance Leistung Power	30 kW
Couple MAX. Drehmoment MAX. Torque MAX.	1500 Nm
Rapport Verhältnis Ratio	i = 1 à 1

Puissance et couple maxi
Leistung und Drehmoment max
Power and torque max

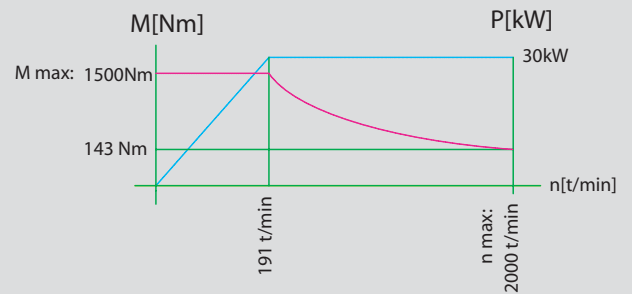

PIBOMULTI
SWISS MADE

PIBOMULTI
SWISS MADE

PIBOMULTI
SWISS MADE

PIBOMULTI
SWISS MADE

PIBOMULTI
SWISS MADE

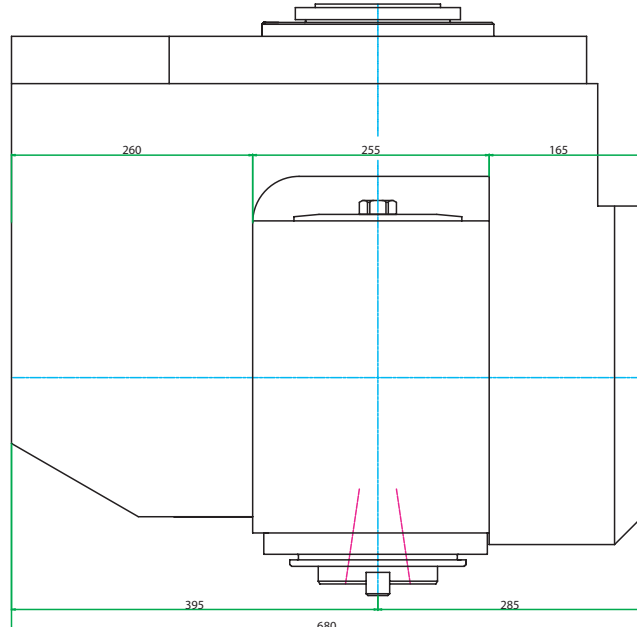
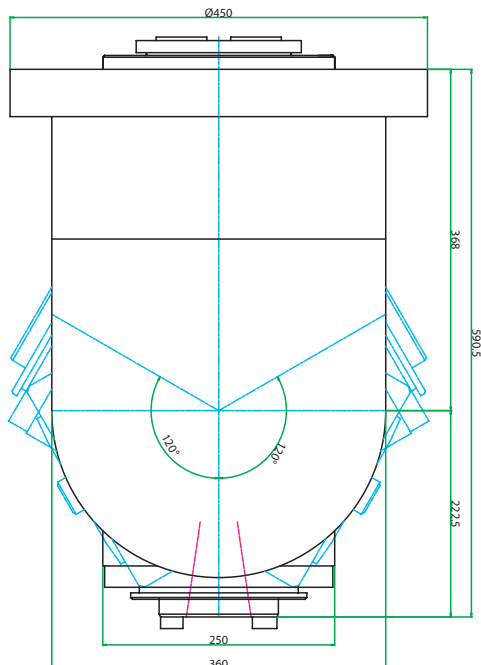

FTARH50-40



Carter Fonte
 Serrage outil manuel
 Positionnement +/- 120° manuel
 Positionnement 360° manuel
 Indexage par denture hirth

Options :
 Arrosage central
 Broche HSK 100
 Serrage outil automatique
 Positionnement +/- 120°, NC tous les 1°
 Positionnement 360°, NC tous les 1°

Cast Iron body
 Manual tool clamping
 Manual positioning +/- 120°
 Manual positioning 360°
 Hirth gear positionning

Options :
 Thru coolant
 Spindle HSK 100
 Automatic tool clamping
 +/- 120°, NC positionning every 1°
 360°, NC positionning every 1°

DONNEES TECHNIQUES TECHNISCHE DATEN TECHNICAL DATA

Type de broche Spindeltyp Spindle type	ISO50 / BT50 Serrage manuel
N max. sortie N max. ausgang N max. output	t/min u/min rpm 1'200
Puissance Leistung Power	40 kW
Couple MAX. Drehmoment MAX. Torque MAX.	3000 Nm
Rapport Verhältnis Ratio	i = 1 à 1

Puissance et couple maxi
 Leistung und Drehmoment max
 Power and torque max

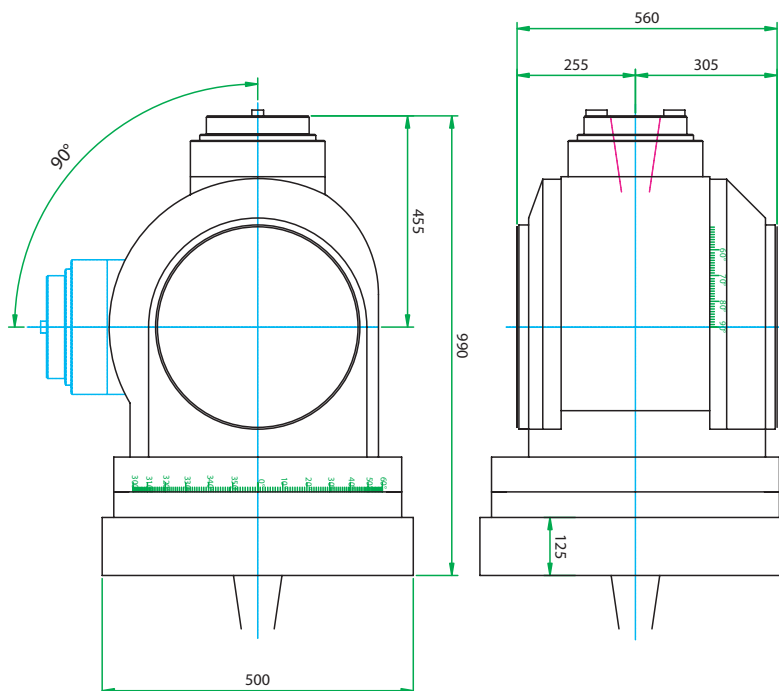
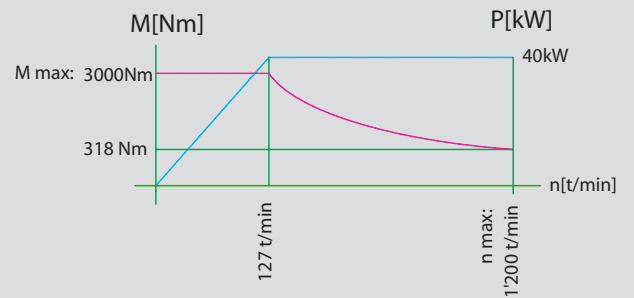

TARR-35



Carter Fonte
Serrage outil manuel
Positionnement 360° radial

Options :
Arrosage central
Broche HSK 100
Serrage outil automatique
Positionnement 360°, NC tous les 1°

Cast Iron body
Manual tool clamping
Radial positioning 360°

Options :
Thru coolant
Spindle HSK 100
Automatic tool clamping
360°, NC positioning every 1°

DONNEES TECHNIQUES TECHNISCHE DATEN TECHNICAL DATA

Type de broche Spindeltyp Spindle type	ISO50
N max. sortie N max. ausgang N max. output	2'000 t/min u/min rpm
Puissance Leistung Power	35 kW
Couple MAX. Drehmoment MAX. Torque MAX.	2000 Nm
Rapport Verhältnis Ratio	i = 1 à 1

Puissance et couple maxi
Leistung und Drehmoment max
Power and torque max

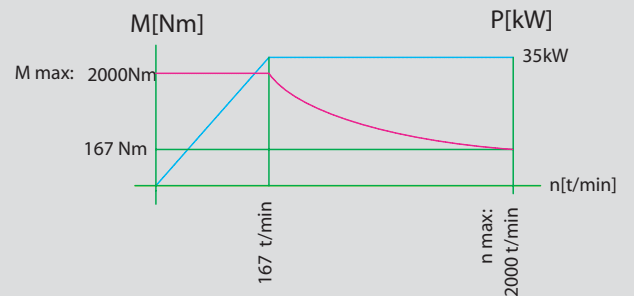

PIBOMULTI
SWISS MADE

PIBOMULTI
SWISS MADE

PIBOMULTI
SWISS MADE

PIBOMULTI
SWISS MADE

PIBOMULTI
SWISS MADE

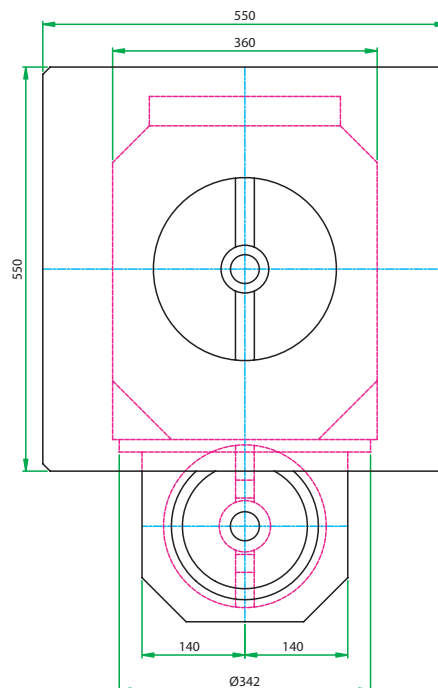
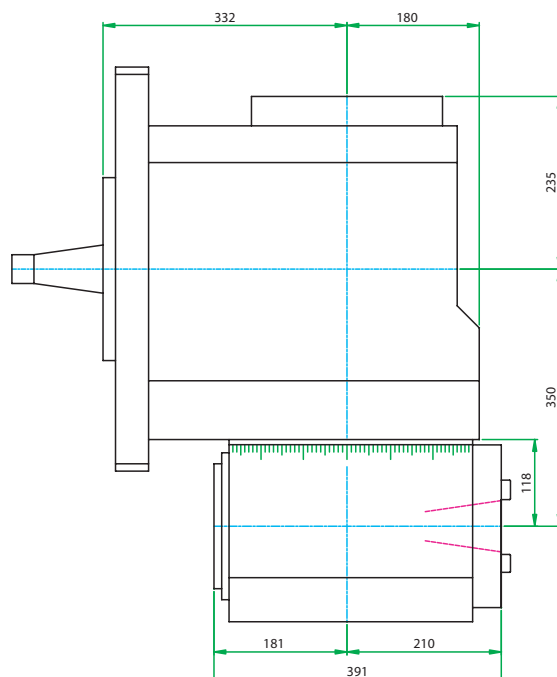

TARR-NC30



Carter Fonte
Serrage outil automatique
**Positionnement 360° et +/- 120°,
NC tous les 1° piloté
par moteur broche de la machine**
Indexion par denture hirth

Options :
Arrosage central
Broche HSK 100 - ISO50

Cast Iron body
Automatic tool clamping
**360° et +/-120° NC positioning
every 1° driven
by machine spindle motor**
Hirth gear index

Options :
Thru coolant
Spindle HSK 100 - ISO50

DONNEES TECHNIQUES TECHNISCHE DATEN TECHNICAL DATA

Type de broche Spindeltyp Spindle type	BT50
N max. sortie N max. ausgang N max. output	3'500 t/min u/min rpm
Puissance Leistung Power	30 kW
Couple MAX. Drehmoment MAX. Torque MAX.	900 Nm
Rapport Verhältnis Ratio	i = 1 à 1

Puissance et couple maxi
Leistung und Drehmoment max
Power and torque max

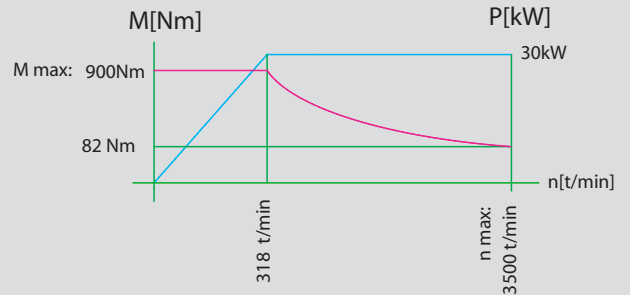

PIBOMULTI
SWISS MADE

PIBOMULTI
SWISS MADE

PIBOMULTI
SWISS MADE

PIBOMULTI
SWISS MADE

PIBOMULTI
SWISS MADE

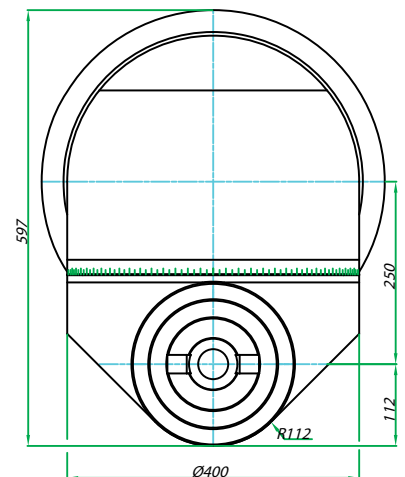
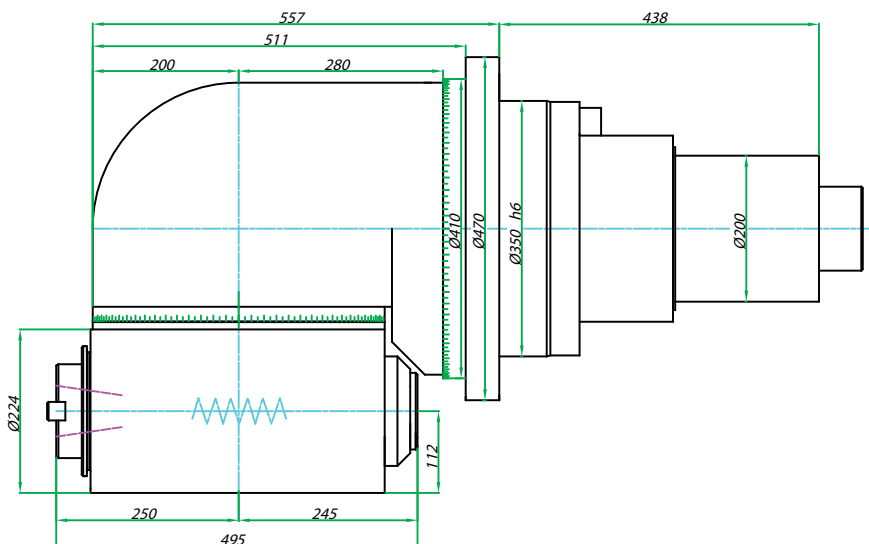

FATCH32-11



Carter Fonte
Serrage outil automatique intégré
Positionnement 360° manuel

Cast Iron body
Integrated automatic tool clamping
Manual positioning 360°

Options :
Arrosage central
Positionnement 360°, NC tous les 1°

Options :
Thru coolant
360°, NC positioning every 1°

DONNEES TECHNIQUES TECHNISCHE DATEN TECHNICAL DATA

Type de broche Spindeltyp Spindle type	HSK32 Serrage automatique
N max. sortie N max. ausgang N max. output	10'200 t/min u/min rpm
Puissance Leistung Power	11 kW
Couple MAX. Drehmoment MAX. Torque MAX.	17 Nm à la broche
Rapport Verhältnis Ratio	i = 1 à 3

Puissance et couple maxi
Leistung und Drehmoment max
Power and torque max

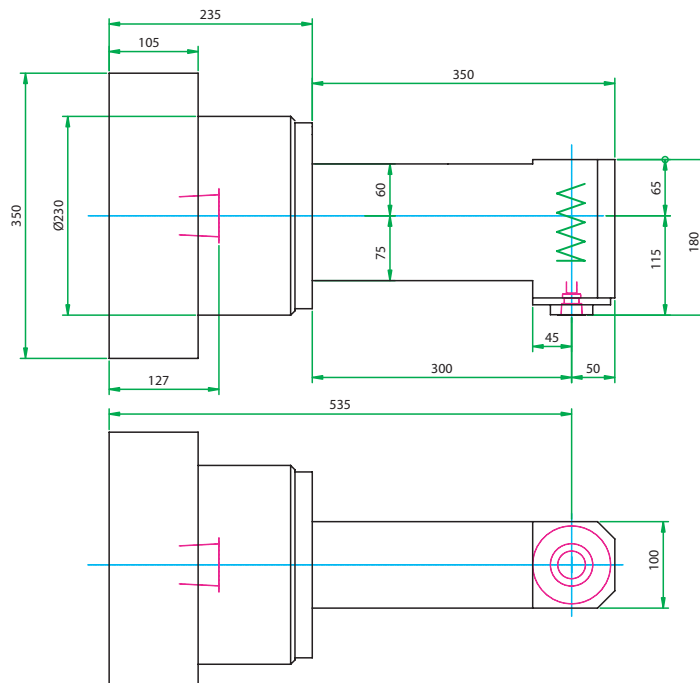
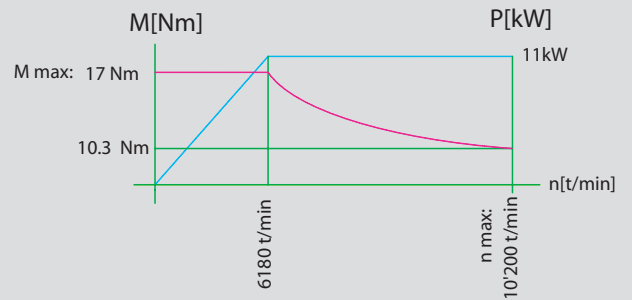

FATCH50-6



Carter Fonte
Serrage outil automatique intégré
Positionnement 360° manuel

Cast Iron body
Integrated automatic tool clamping
Manual positioning 360°

Options :
Arrosage central
Positionnement 360°, NC tous les 1°

Options :
Thru coolant
360°, NC positioning every 1°

DONNEES TECHNIQUES TECHNISCHE DATEN TECHNICAL DATA

Type de broche Spindeltyp Spindle type	HSK50 Serrage automatique
N max. sortie N max. ausgang N max. output	t/min u/min rpm 3'000
Puissance Leistung Power	6 kW
Couple MAX. Drehmoment MAX. Torque MAX.	100 Nm
Rapport Verhältnis Ratio	i = 1 à 1

Puissance et couple maxi
Leistung und Drehmoment max
Power and torque max

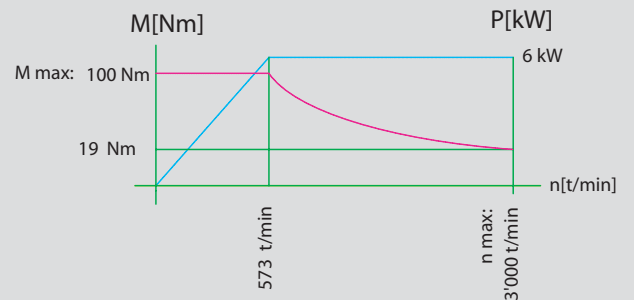

PIBOMULTI
SWISS MADE

PIBOMULTI
SWISS MADE

PIBOMULTI
SWISS MADE

PIBOMULTI
SWISS MADE

PIBOMULTI
SWISS MADE

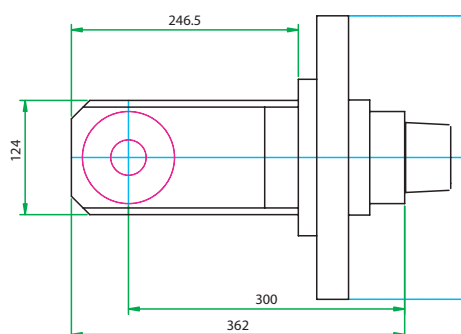
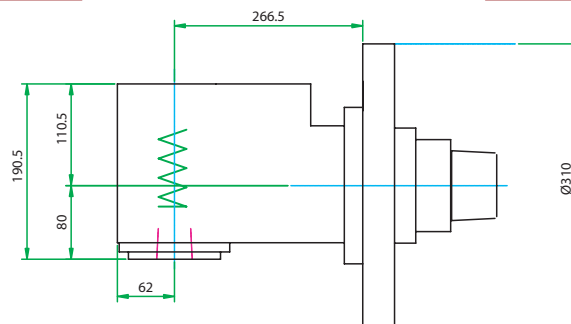

FATC40-10



Carter Fonte
Serrage outil automatique intégré
Positionnement 360° manuel

Cast Iron body
Integrated automatic tool clamping
Manual positioning 360°

Options :
Arrosage central
Positionnement 360°, NC tous les 1°

Options :
Thru coolant
360°, NC positioning every 1°

DONNEES TECHNIQUES TECHNISCHE DATEN TECHNICAL DATA

Type de broche Spindeltyp Spindle type	ISO40 / BT40 Serrage automatique
N max. sortie N max. ausgang N max. output	2'000 t/min u/min rpm
Puissance Leistung Power	10 kW
Couple MAX. Drehmoment MAX. Torque MAX.	200 Nm
Rapport Verhältnis Ratio	i = 1 à 1

Puissance et couple maxi
Leistung und Drehmoment max
Power and torque max

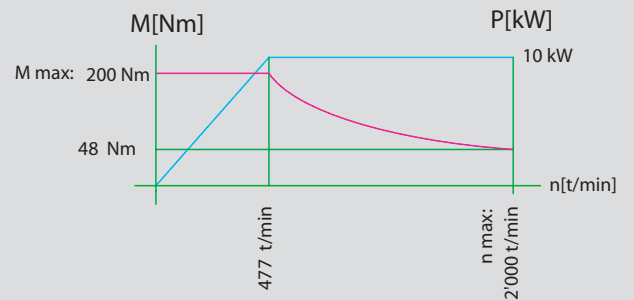

PIBOMULTI
SWISS MADE

PIBOMULTI
SWISS MADE

PIBOMULTI
SWISS MADE

PIBOMULTI
SWISS MADE

PIBOMULTI
SWISS MADE

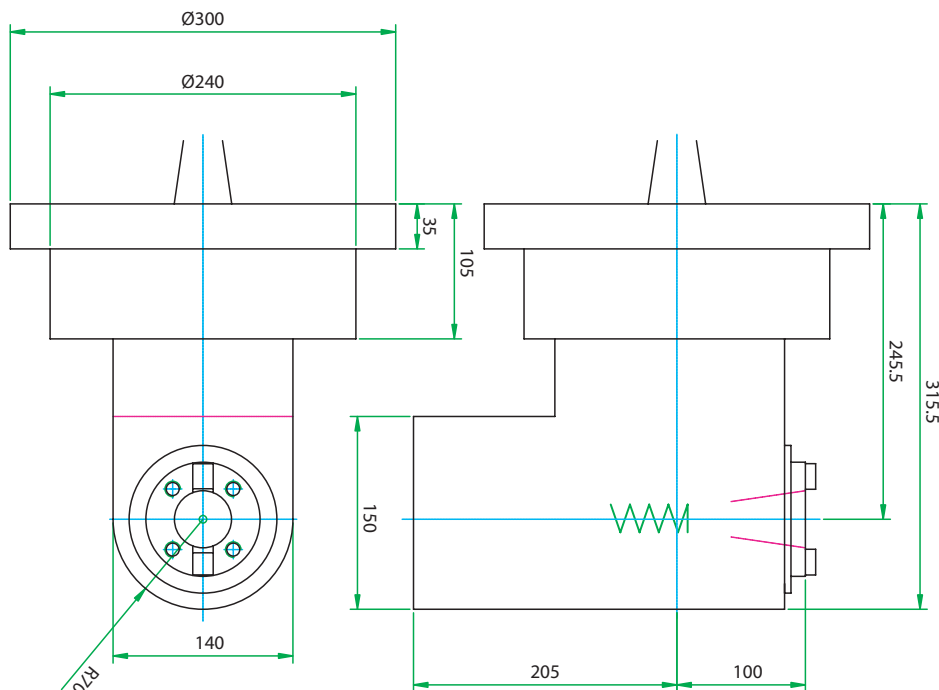

FATC50-20



Carter Fonte
Serrage outil automatique intégré
Positionnement 360° manuel

Cast Iron body
Integrated automatic tool clamping
Manual positioning 360°

Options :
Arrosage central
Positionnement 360°, NC tous les 1°

Options :
Thru coolant
360°, NC positioning every 1°

DONNEES TECHNIQUES TECHNISCHE DATEN TECHNICAL DATA

Type de broche Spindeltyp Spindle type	ISO50 / BT50 Serrage automatique
N max. sortie N max. ausgang N max. output	2'000 t/min u/min rpm
Puissance Leistung Power	20 kW
Couple MAX. Drehmoment MAX. Torque MAX.	600 Nm
Rapport Verhältnis Ratio	i = 1 à 1

Puissance et couple maxi
Leistung und Drehmoment max
Power and torque max

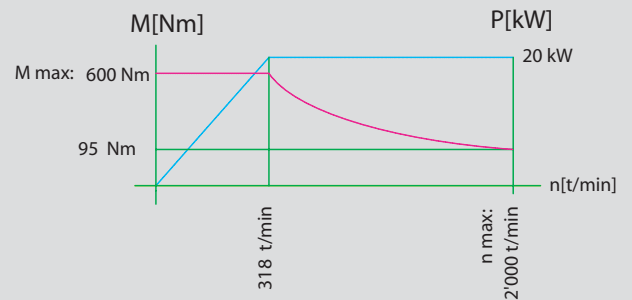

PIBOMULTI
SWISS MADE

PIBOMULTI
SWISS MADE

PIBOMULTI
SWISS MADE

PIBOMULTI
SWISS MADE

PIBOMULTI
SWISS MADE

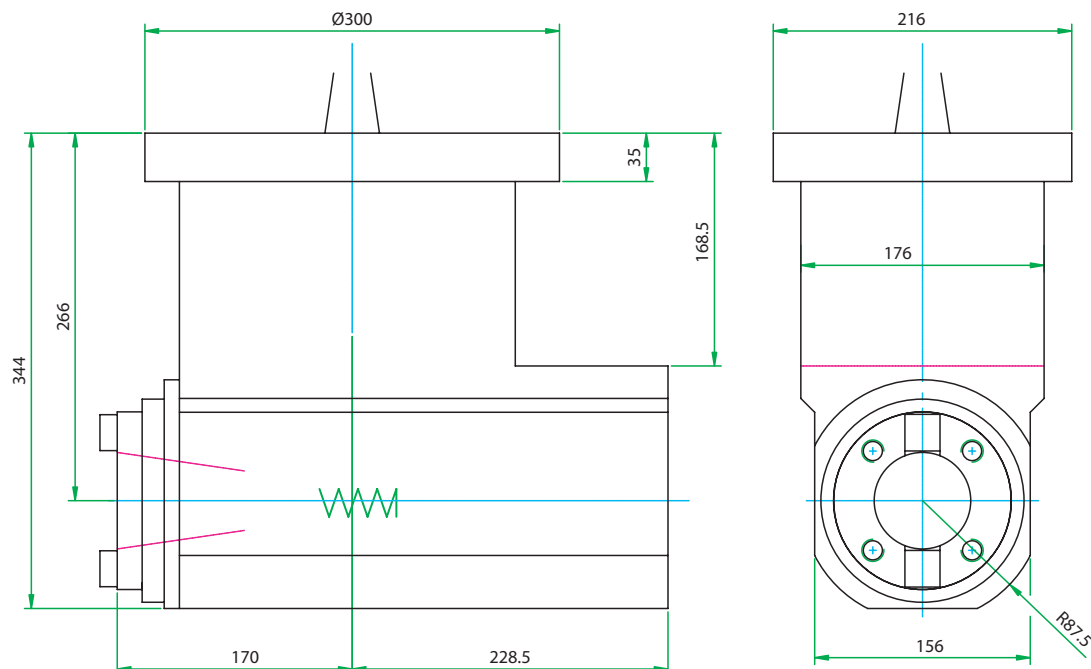

FATC60-113



Carter Fonte
Serrage outil automatique intégré
Positionnement 360° manuel

Cast Iron body
Integrated automatic tool clamping
Manual positioning 360°

Options :
Arrosage central
Positionnement 360°, NC tous les 1°

Options :
Thru coolant
360°, NC positioning every 1°

DONNEES TECHNIQUES TECHNISCHE DATEN TECHNICAL DATA

Type de broche Spindeltyp Spindle type	ISO60 / BT60 Serrage automatique
N max. sortie N max. ausgang N max. output	t/min u/min rpm 1'000
Puissance Leistung Power	113 kW
Couple MAX. Drehmoment MAX. Torque MAX.	10'000 Nm à la broche
Rapport Verhältnis Ratio	i = 2 à 1

Puissance et couple maxi
Leistung und Drehmoment max
Power and torque max

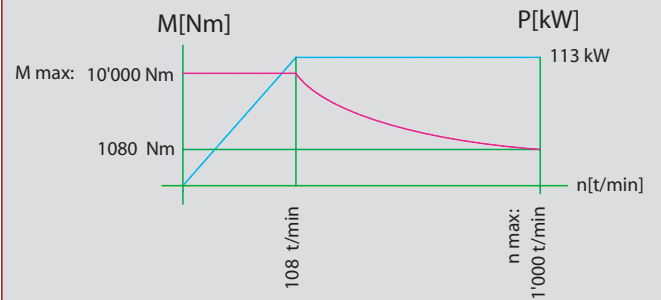

PIBOMULTI
SWISS MADE

PIBOMULTI
SWISS MADE

PIBOMULTI
SWISS MADE

PIBOMULTI
SWISS MADE

PIBOMULTI
SWISS MADE

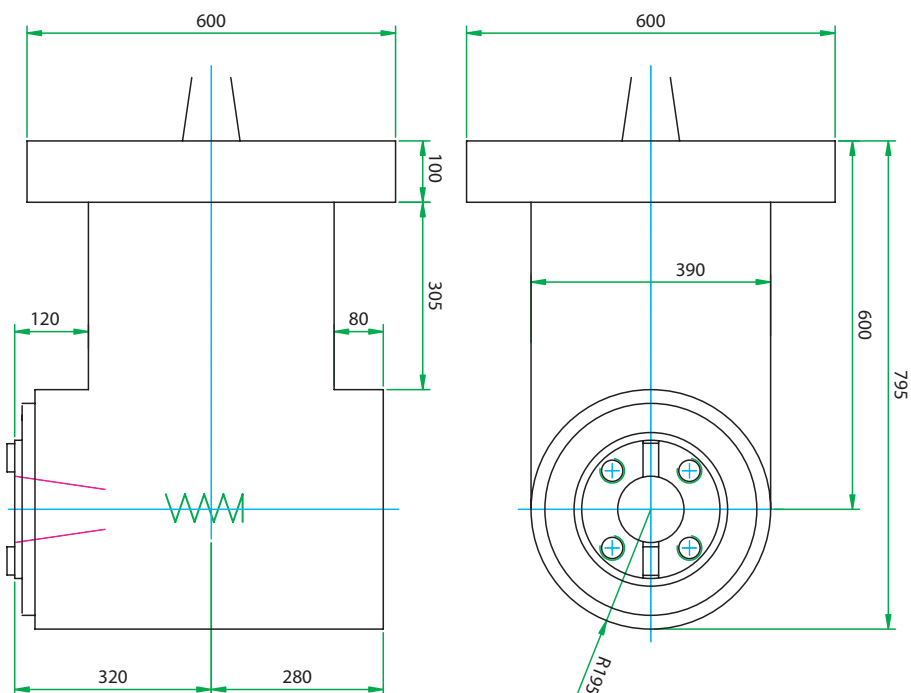

SPINDLE EXTENTION

3'000 rpm



Carter Fonte
Broche BT 50
Rapport de vitesse 1 à 1
Serrage outil automatique

Options :
Arrosage central
Broche HSK 100 / ISO 50

Cast Iron body
Spindle BT 50
Integrated ratio 1 to 1
Automatic tool clamping

Options :
Thru coolant
Spindle HSK 100 / ISO 50

DONNEES TECHNIQUES TECHNISCHE DATEN TECHNICAL DATA

Type de broche Spindeltyp Spindle type	ISO50 / BT50 Serrage automatique
N max. sortie N max. ausgang N max. output	3000 t/min u/min rpm
Puissance Leistung Power	52 kW
Couple MAX. Drehmoment MAX. Torque MAX.	2400 Nm
Rapport Verhältnis Ratio	i = 1 à 1

Puissance et couple maxi
Leistung und Drehmoment max
Power and torque max

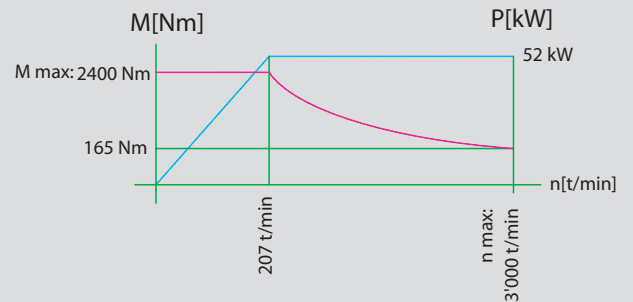

PIBOMULTI
SWISS MADE

PIBOMULTI
SWISS MADE

PIBOMULTI
SWISS MADE

PIBOMULTI
SWISS MADE

PIBOMULTI
SWISS MADE

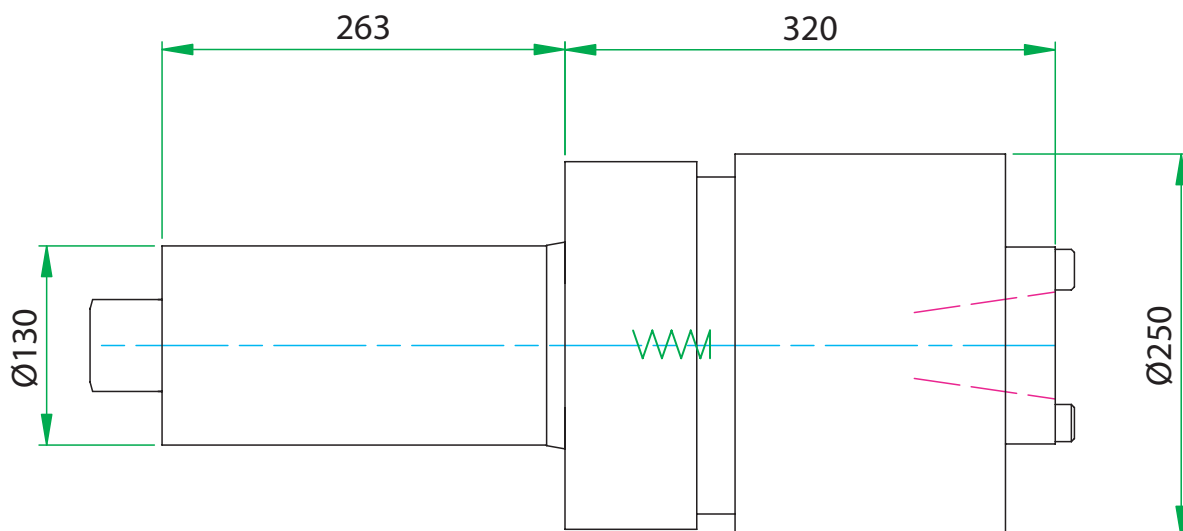

SPINDLE EXTENTION

6'000 rpm



Carter Fonte
Course 200 mm intégrée
Broche CAPTO 8
Rapport de vitesse 1 à 4
Serrage outil manuel

Options :
Arrosage central
Broche HSK 100 / ISO 50

Cast Iron body
200 mm stroke integrated
Spindle CAPTO 8
Integrated ratio 1 to 4
Manual tool clamping

Options :
Thru coolant
Spindle HSK 100 / ISO 50

DONNEES TECHNIQUES TECHNISCHE DATEN TECHNICAL DATA

Type de broche Spindeltyp Spindle type	CAPTO 8 Serrage manuel
N max. sortie N max. ausgang N max. output	6000 t/min u/min rpm
Puissance Leistung Power	20 kW
Couple MAX. Drehmoment MAX. Torque MAX.	500 Nm à la broche
Rapport Verhältnis Ratio	i = 1 à 4

Puissance et couple maxi
Leistung und Drehmoment max
Power and torque max

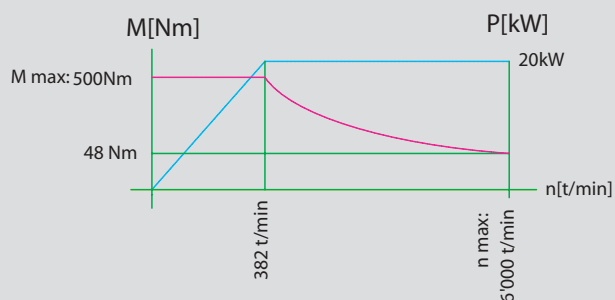

PIBOMULTI
SWISS MADE

PIBOMULTI
SWISS MADE

PIBOMULTI
SWISS MADE

PIBOMULTI
SWISS MADE

PIBOMULTI
SWISS MADE

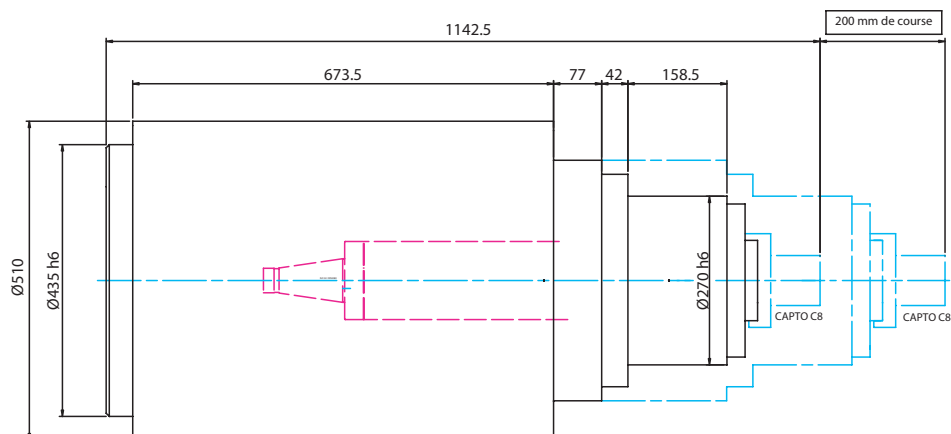

SPINDLE EXTENTION

8'000 rpm



Carter Fonte
Broche ISO 50
Rapport de vitesse 1 à 4
Serrage outil automatique intégré

Options :
Arrosage central
Broche HSK 100

Cast Iron body
Spindle ISO 50
Integrated ratio 1 to 4
Integrated automatic tool clamping

Options :
Thru coolant
Spindle HSK 100

DONNEES TECHNIQUES TECHNISCHE DATEN TECHNICAL DATA

Type de broche Spindeltyp Spindle type	ISO50 / 7388/Z Serrage automatique
N max. sortie N max. ausgang N max. output	8000 t/min u/min rpm
Puissance Leistung Power	20 kW
Couple MAX. Drehmoment MAX. Torque MAX.	500 Nm à la broche
Rapport Verhältnis Ratio	i = 1 à 4

Puissance et couple maxi
Leistung und Drehmoment max
Power and torque max

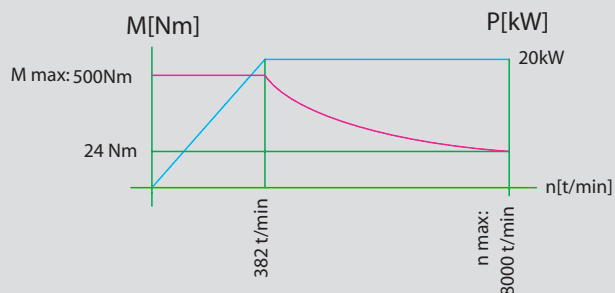

PIBOMULTI
SWISS MADE

PIBOMULTI
SWISS MADE

PIBOMULTI
SWISS MADE

PIBOMULTI
SWISS MADE

PIBOMULTI
SWISS MADE

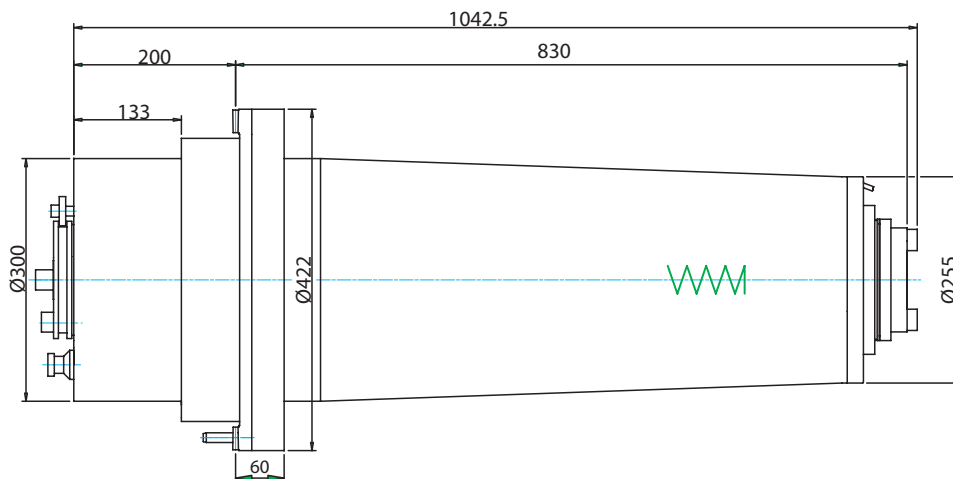

Multiplicateur à grand rendement et de grande puissance
Schnellaufspindeln für hohe Produktivität und grosser Leistung
Speeders for high productivity and big power

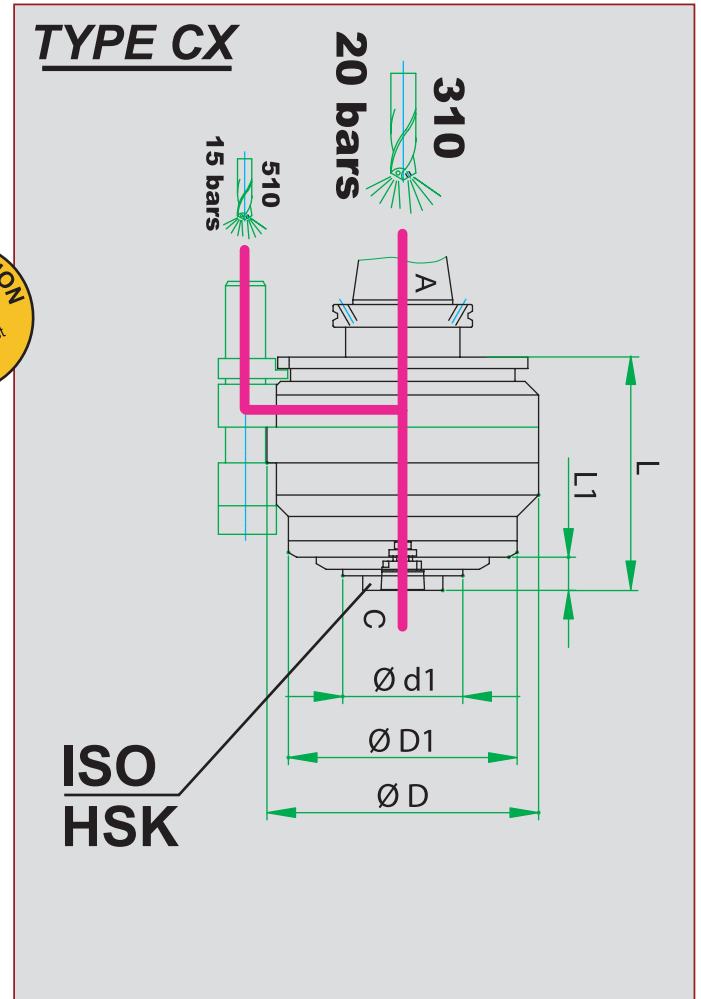
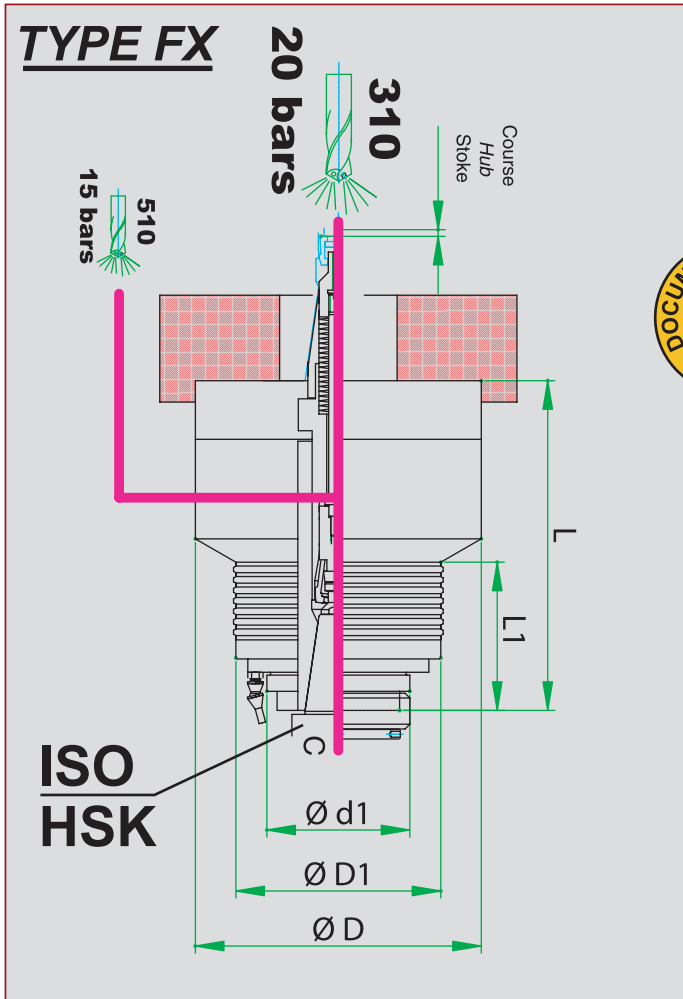

DOCUMENTATION
 sur demande
 auf Anfrage
 on request



Caractéristiques / Angaben Features						Dimensions						
Type	n	n max.	kW	Nm	C	d1	D	D1	L	L1	kg	
FX190-05	1+5	10'000	12'000	10	130	ISO30/HSK50	121	190	150	210	130	30
FX210-04	1+4	8'000	10'000	12	260	ISO40/HSK63	142	210	185	240	138	45
FX300-04	1+4	6'000	8'000	20	405	ISO50/HSK100	150	300	220	346	156	110
FX375-06	1+6	4'000	5'000	30	830	ISO50/HSK100	180	375	250	385	129	190

Données techniques voir page 47

■ :standard - Standard - standard ▲ :sur demande - auf Anfrage - on request

Caractéristiques / Angaben Features						Dimensions						A ISO - BT - CAT	
Type	n	n max.	kW	Nm	C	d1	D	D1	L	L1	kg	50	60
CX1905	1+5	8'000	10'000	10	190	ISO30/HSK50	121	190	160	230	60	29	■
CX2104	1+4	8'000	10'000	12	260	ISO40/HSK63	150	210	186	240	80	38	■
CX3504	1+4	4'000	5'000	30	1000	ISO50/HSK100	190	350	290	400	197	185	■

Données techniques voir page 47

Ecrou de serrage rapide Pibomulti
Schnellwechsellmutter Pibomulti
Pibomulti quick change nut

Type	Cône outils	d1	L	L1	L2
SER4001-000	ISO 40 DIN 2080	110	43,5	33	28,5
SER4002-000	ISO 40 DIN 69871-A ou CAT 40	110	43,5	33	28,5
SER4004-000	BT 40	110	47	37	32
SER5001-000	ISO 50 DIN 2080	150	48	37,5	30
SER5002-000	ISO 50 DIN 69871-A ou CAT 50	150	48	37,5	30
SER5004-000	BT 50	150	56,5	46	38,5

Option 310

Pression / Druck / Pressure 20 bars
 Arrosage central avec entrée centrale.
 Innere Kühlmittelzufuhr mit Eintritt durch das Zentrum.
 Thru coolant with center input.

Option 510

Pression / Druck / Pressure 15 bars
 Arrosage central avec entrée latérale.
 Innere Kühlmittelzufuhr mit seitlichem Eintritt.
 Thru coolant with side input.

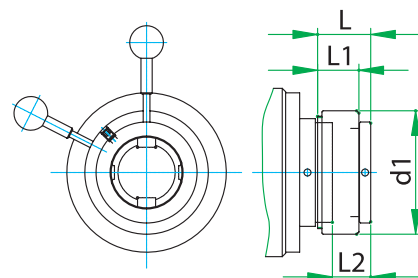

INFORMATIONS TECHNIQUES - TECHNISCHE INFORMATIONEN

TECHNICAL INFORMATION

Graphique de puissance-couple
et "n" en continu
Drehmoment und
Dauerlaufdiagramm
Power-torque
and "n" in continuous
diagram

Puissance et couple maxi
Leistung und Drehmoment max
Power and torque max

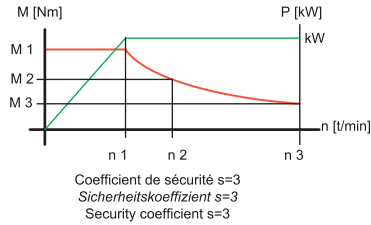

Temps d'utilisation en fonction de la vitesse
Einsatzdauer in Bezug zur max. Drehzahl
Using time in terms of speed

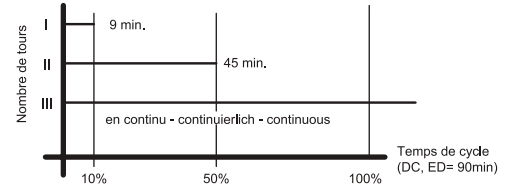

Type	Couple (Nm)			Nbr. de tours (t/min)			Puissance
	M1	M2	M3	n1	n2	n3	kW
X635	7	1.6	0.54	2'320	10'000	30'000	1.7
X766	8	2.7	0.9	3'340	10'000	30'000	2.8
X9810	5	1	0.5	3'800	20'000	40'000	2
X9810-50	5	1	0.4	3'800	20'000	50'000	2
X765	12	3.3	1.5	2'800	10'000	22'000	3.5
X986	18	4.3	2.1	3'390	10'000	20'000	4.5
X1055	29	6.1	3.6	2'100	10'000	17'000	6.4
X1057	5.7	3.8	2.1	6'700	10'000	18'000	4
X1205	34	6.7	4.4	2'000	10'000	15'000	7
X1505	39	15.3	6.3	2'000	5'000	12'000	8
XM1506	24	15.3	6.4	3'180	5'000	12'000	8
X1905	130	32	9.5	730	3'000	10'000	10
FX190-05 / CX1905	130	32	8	730	3'000	12'000	10
FX210-04 / CX2104	260	38	11.5	440	3'000	10'000	12
FX300-04	405	87	24	471	2'200	8'000	20
CX3504	1'000	280	125	300	1'000	2'300	30
FX375-06	830	130	57	345	2'200	5'000	30
X635T	7	1.9	0.6	2'700	10'000	30'000	2
X9810T	5	0.9	0.5	3'800	20'000	40'000	2
X765T	12	3.8	1.7	3'200	10'000	22'000	4
X1055T	29	7.7	5.1	2'100	8'000	12'000	6.4
X1205T	34	7.6	5	2'250	10'000	15'000	8

Type	Nbr. de tours (t/min)		
	I	II	III
X635	30'000	25'000	20'000
X766	30'000	25'000	20'000
X9810	40'000	36'000	28'800
X9810-50	50'000	44'000	35'200
X765	22'000	18'000	14'400
X986	20'000	16'000	12'800
X1055	17'000	13'000	10'400
X1057	18'000	15'000	12'000
X1205	15'000	12'000	9'600
X1505	12'000	10'000	8'000
XM1506	12'000	10'000	8'000
X1905	10'000	8'000	6'400
FX190-05 / CX1905	12'000	10'000	8'000
FX210-04 / CX2104	10'000	8'000	6'400
FX300-04	8'000	6'000	4'800
CX3504	5'000	4'000	3'200
FX375-06	5'000	4'000	3'200
X635T	30'000	25'000	20'000
X9810T	40'000	36'000	28'800
X765T	22'000	18'000	14'400
X1055T	12'000	8'000	6'400
X1205T	15'000	12'000	9'600



Données techniques

↔ : entrée - sortie
n : U/min 50% DC
n max. : U/min 10% DC
DC,ED : durée du cycle 90 min

kW : puissance en kW (n)
Nm : Couple Nm (n)
kg : poids en kg

Technische Daten

↔ : Eingang - Ausgang
n : U/Min 50% DC
n max. : U/Min 10% DC
DC,ED : Zyklusdauer 90 Min

kW : Leistung kW (n)
Nm : Drehmoment Nm (n)
kg : Gewicht in kg

Technical data

↔ : Input - output
n : rpm 50% DC
n max. : rpm 80% DC
DC,ED : duty cycle 90 Min

kW : power in kW (n)
Nm : torque Nm (n)
kg : weight in kg

MB-01



Poids : 1200 kg
Perçage : Ø 51 / 58
Taraudage M56 x 5

arrosage par le centre des outils

Weight : 1200 kg
Drilling : Ø 51 / 58
Tapping M56 x 5

Thru coolant

DONNEES TECHNIQUES TECHNISCHE DATEN TECHNICAL DATA

Type de broche Spindeltyp Spindle type	ABS 100
N max. sortie N max. ausgang N max. output	t/min u/min rpm 1'350 aux broches
Puissance Leistung Power	80 kW
Couple MAX. Drehmoment MAX. Torque MAX.	5'600 Nm aux broches
Rapport Verhältnis Ratio	i = 1 à 1.5

Puissance et couple maxi
Leistung und Drehmoment max
Power and torque max

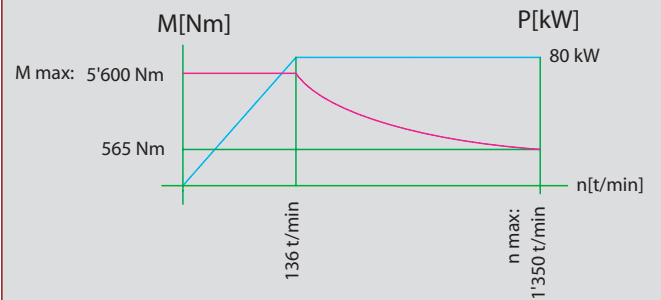

PIBOMULTI
SWISS MADE

PIBOMULTI
SWISS MADE

PIBOMULTI
SWISS MADE

PIBOMULTI
SWISS MADE

PIBOMULTI
SWISS MADE

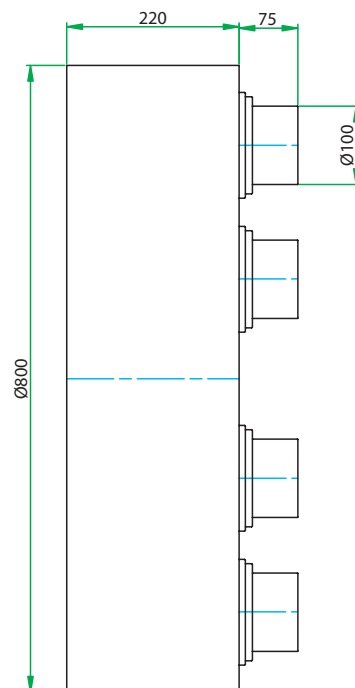
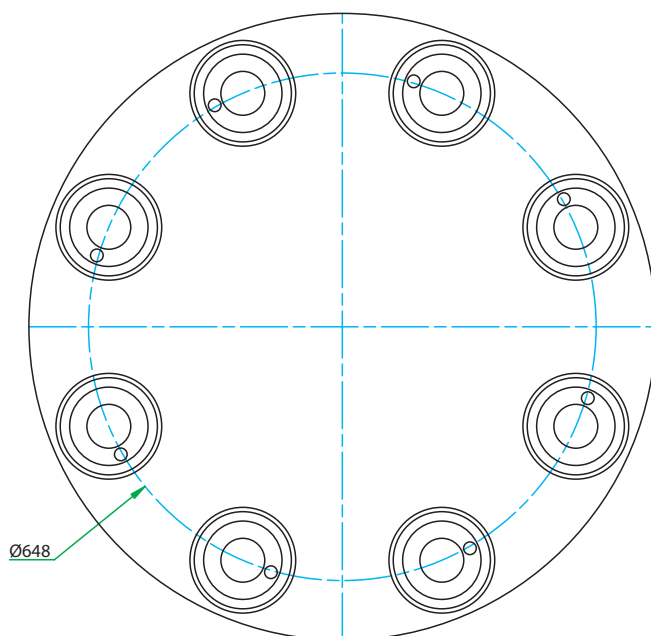



FTARH60- 80 Tête angulaire réglable
Cône ISO 60 80 kW

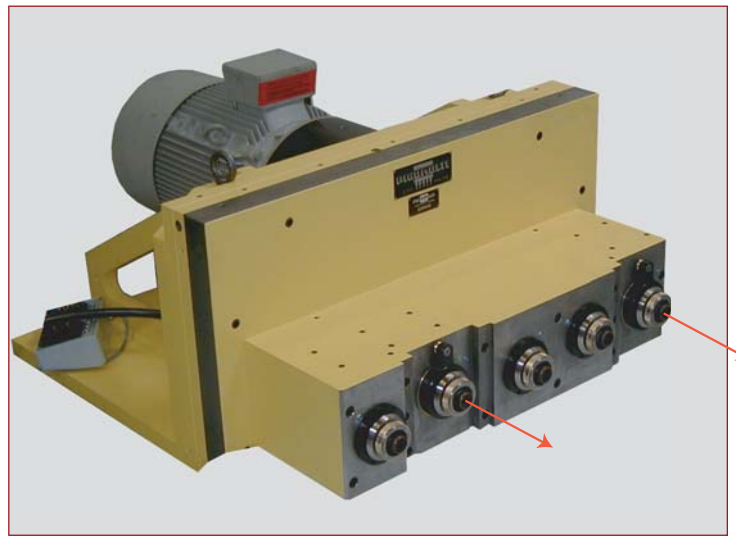

Tête à broches alternées
3 broches fixes - 2 broches mobiles



Tête angulaire
Grande puissance - volume réduit

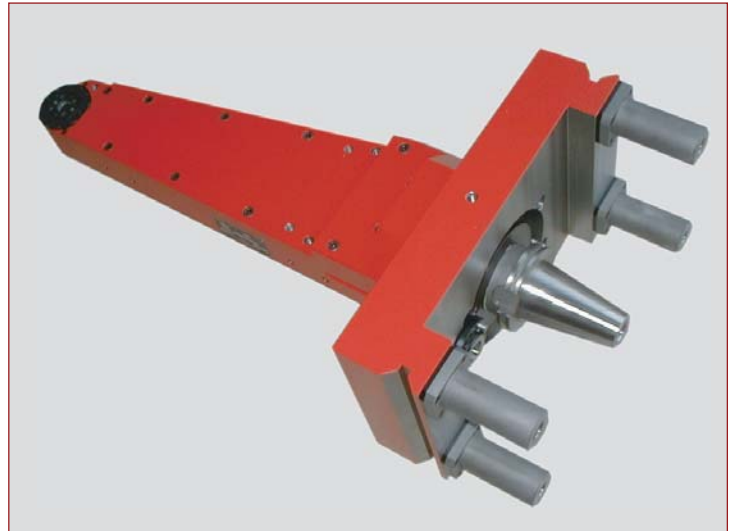

Tête angulaire
Usinage moteur Diesel



Tête angulaire avec multiplication intégrée 1 à 4
ISO 30 - ISO 40 - ISO 50 6'000 - 12'000 rpm



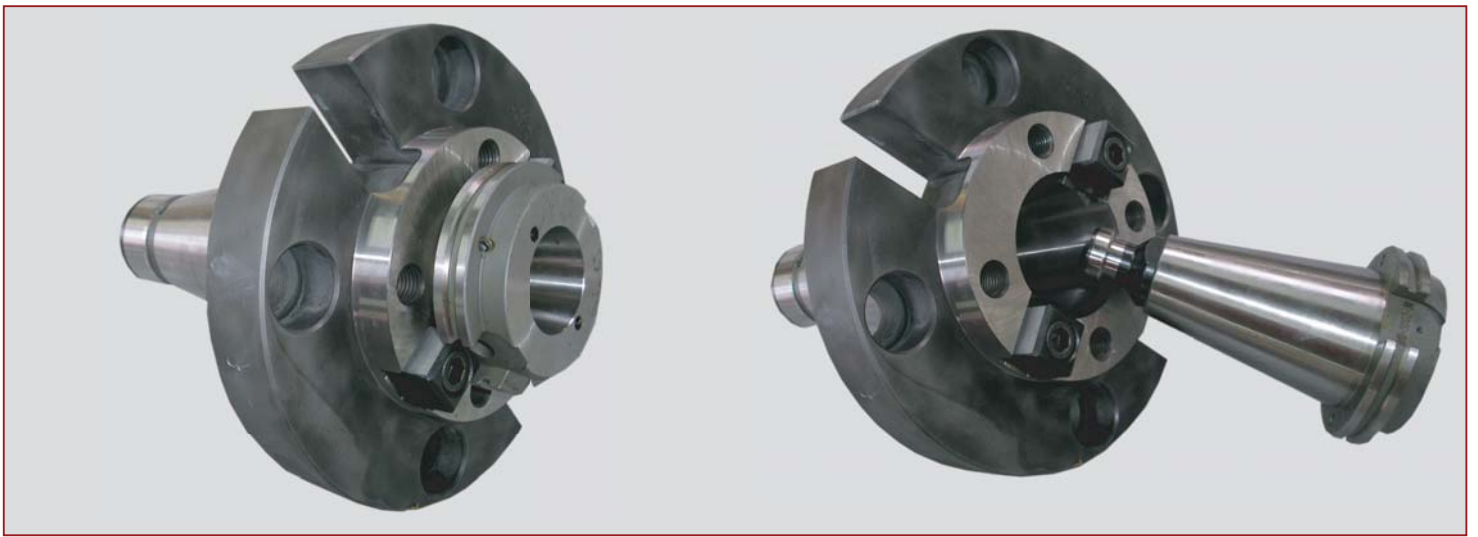

Réduction ISO 60 - ISO 50
avec serrage automatique intégré

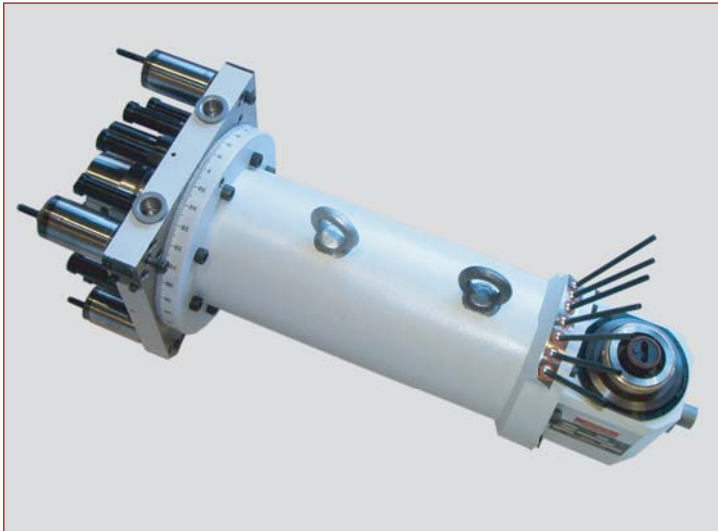

Tête angulaire
L= 600 mm - Broche HSK 63



Multiplicateur FX460
 $i= 1\text{ à }4$ n max =6'000 rpm - **500 Nm**

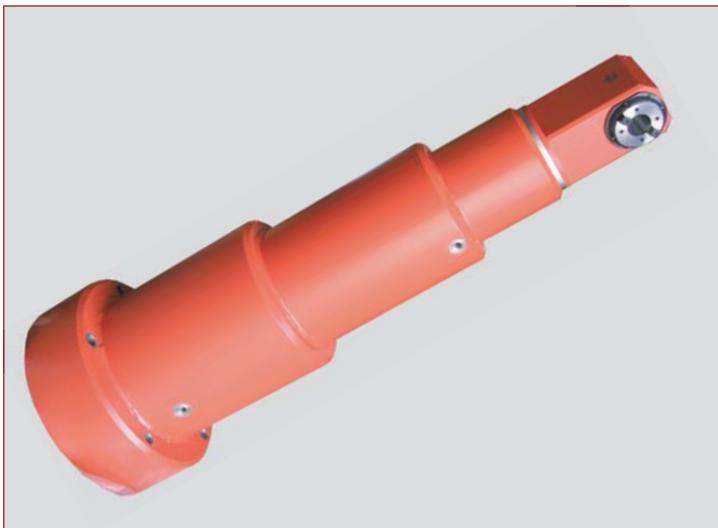

Tête angulaire
L=1300 mm

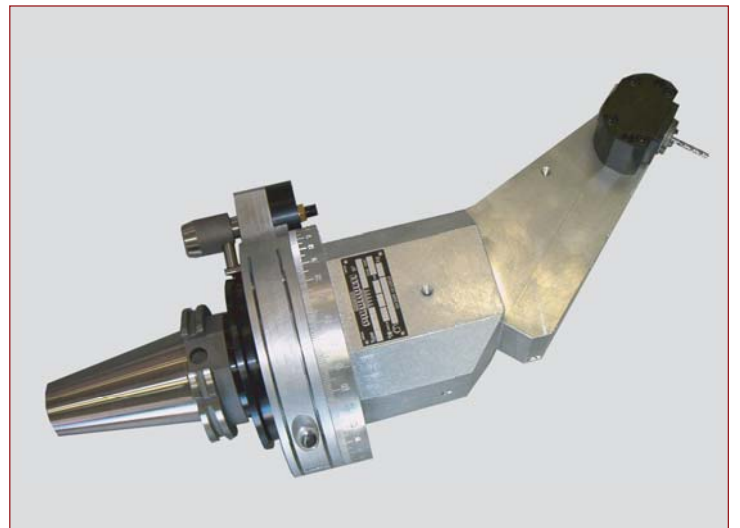

Tête angulaire
Usinage interne bloc moteur